

TECHNICAL SPECIFICATIONS



LA5BFC60

5MP NDAA 4-in-1 2.8mm Full Color

LA5BFC60

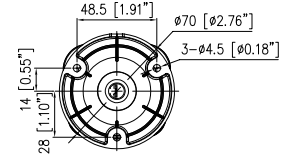
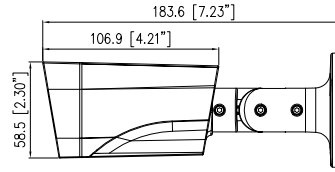
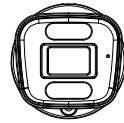

FEATURES:

- ◆ NDAA Compliant
- ◆ Supports TVI, CVI, AHD & 960H Formats
- ◆ 5MP Resolution (2560×1944) @20FPS
- ◆ True 120dB Wide Dynamic Range
- ◆ IR Cut Filter
- ◆ Fixed 2.8mm IR Lens
- ◆ Full Color, 2 White Light LED - 60' Range
- ◆ UTC & Cable OSD Control
- ◆ 12 Volt DC Power
- ◆ IP66 Weatherproof

INCLUDED ACCESSORIES:

- 1x Quick start guide
- 1x Hex wrench
- 4x Mounting inserts & screws
- 1x Mounting template

	FEATURES	LA5BFC60
Camera	Image Sensor	1/2.8" CMOS
	Scanning System	Progressive Scan
	Resolution	5MP (2560×1944)
	Signal System	NTSC / PAL
	Shutter Speed	Auto, Manual 1/25 ~ 1/10,000
	Minimum Illumination	Color: 0.01 Lux @ (F1.2,AGC ON); B/W: 0 Lux @ (IR LED ON)
	S/N Ratio	More than 50dB
	Sync System	Internal
	Camera Bracket Adjustment	Pan:0°~360°; Tilt:0°~90°; Rotation:0°~360°
	Lens	Lens Type / Viewing Angle
IR Cut Filter		Yes
LED Count / Range		2 White Light LEDs / 60' Range
Video & OSD	Video Output	Single BNC Output - Supports TVI, CVI, AHD & 960H Formats (Selectable via OSD Cable)
	Frame Rate	AHD/TVI: 5MP @ 20/12.5fps, 4MP @ 25/30/15fps, CVI: 4MP @ 25/30fps, CVBS: PAL/NTSC
	True WDR (Wide Dynamic Range)	Yes- 120dB
	OSD (On Screen Display)	Dual OSD Access: Cable OSD Controlled / UTC Controlled (coaxial control)
	Day & Night	Yes - True Day/Night with IR Filter - Auto Switch
	DNR (Digital Noise Reduction)	2DNR & 3DNR, Auto / Manual (0-100 Adjustable)
	Automatic Gain Control	Auto, Manual 0 ~16 Adjustable
	Gamma Characteristics	y = 0.45 typ
	White Balance	ATW, MWB - R & B Gain 0~32 Adjustable
	Back Light Compensation	Globe / BLC / 1~8 Adjustable
	Day/Night	EXT / Auto / Color / B/W
Languages	English, French, Spanish, Italian (see OSD Menu for more)	
Brightness	0 ~30 Adjustable	
General	Power Input	12 Volt DC Only ±10%
	Power Consumption & Current	Max. 6W (12V DC, LED ON)
	Overall Camera Dimensions	194.4× 64 × 64mm (7.63" × 2.52" × 2.52")
	Housing / Color	Aluminum / White
	Net Weight	0.29 kg (0.64 lb)
	Operating Temperature	-25 °C ~ 55 °C (-14°F ~ 131 °F)
	Weatherproof Rating	IP67

TECHNICAL SPECIFICATIONS



LA5BFC60

Optional Mounting Accessories for LA5BFC60:

L3JB1 Junction box

Features:

- ◆ Manages & Protects Cables
- ◆ 3/4" Conduit Access
- ◆ For Indoor & Outdoor Use



L3JB1

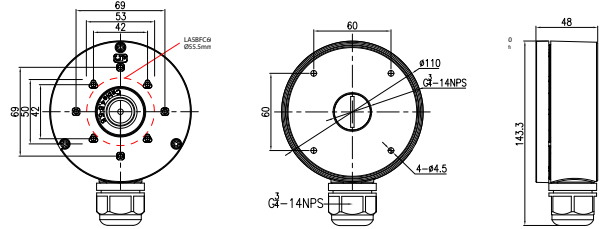

L3JB1 Lineart

L3POLEMT2 Pole mount

Features:

- ◆ Metal Straps Included
- ◆ For 5-6" Pole Diameters
- ◆ For Indoor & Outdoor Use



L3POLEMT2

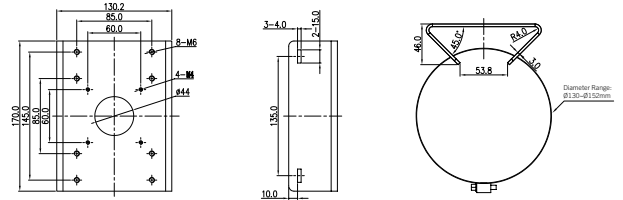

L3POLEMT2 Lineart

TECHNICAL SPECIFICATIONS

5MP NDA4 4-in-1 2.8mm IR LED

LA5BIR80



LA5BIR80

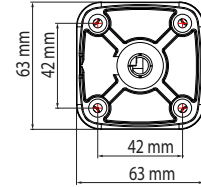
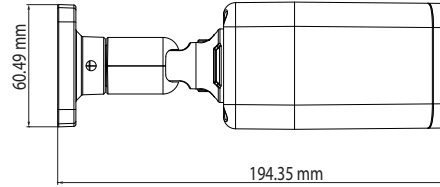

FEATURES:

- ◆ NDA4 Compliant
- ◆ Supports TVI, CVI, AHD & 960H Formats
- ◆ 5MP Resolution (2560×1944) @20FPS
- ◆ True 120dB Wide Dynamic Range
- ◆ True Day/Night IR Cut Filter
- ◆ Fixed 2.8mm IR Lens
- ◆ Up to 80' IR Range
- ◆ UTC & Cable OSD Control
- ◆ 12 Volt DC Power
- ◆ IP67 Weatherproof

INCLUDED ACCESSORIES:

- 1x Quick start guide
- 1x Hex wrench
- 4x Mounting inserts & screws
- 1x Mounting template

	FEATURES	LA5BIR80
Camera	Image Sensor	1/2.8" CMOS
	Scanning System	Progressive Scan
	Resolution	5MP (2560×1944)
	Signal System	NTSC / PAL
	Shutter Speed	Auto, Manual 1/25 ~ 1/10,000
	Minimum Illumination	Color: 0.01 Lux @ (F1.2, AGC ON); B/W: 0 Lux @ (IR LED ON)
	S/N Ratio	More than 50dB
	Sync System	Internal
	Camera Bracket Adjustment	Pan:0°~360°; Tilt:0°~90°; Rotation:0°~360°
Lens	Lens Type / Viewing Angle	2.8mm IR Lens / H: 90.4°, V: 65.8°
	True Day/Night	Yes - Removeable IR Cut Filter
	IR LED Count / Range / nM	24 IR LED's / 80' Range / 850nm
Video & OSD	Video Output	Single BNC Output - Supports TVI, CVI, AHD & 960H Formats (Selectable via OSD Cable)
	Frame Rate	AHD/TVI: 5MP @ 20/12.5fps, 4MP @ 25/30/15fps, CVI: 4MP @ 25/30fps, CVBS: PAL/NTSC
	True WDR (Wide Dynamic Range)	Yes- 120dB
	OSD (On Screen Display)	Dual OSD Access: Cable OSD Controlled / UTC Controlled (coaxial control)
	Day & Night	Yes - True Day/Night with IR Filter - Auto Switch
	DNR (Digital Noise Reduction)	2DNR & 3DNR, Auto / Manual (0-100 Adjustable)
	Automatic Gain Control	Auto, Manual 0 ~16 Adjustable
	Gamma Characteristics	y = 0.45 typ
	White Balance	ATW, MWB - R & B Gain 0~32 Adjustable
	Back Light Compensation	Globe / BLC / 1~8 Adjustable
	Day/Night	EXT / Auto / Color / B/W
	Languages	English, French, Spanish, Italian (see OSD Menu for more)
Brightness	0 ~30 Adjustable	
General	Power Input	12 Volt DC Only ±10%
	Power Consumption & Current	Max. 4W (12V DC, IR ON)
	Overall Camera Dimensions	194.4× 64 × 64mm (7.63" × 2.52" × 2.52")
	Housing / Color	Aluminum / White
	Net Weight	0.49 kg (1.08 lb)
	Operating Temperature	-25 °C ~ 55 °C (-14°F ~ 131 °F)
Weatherproof Rating	IP67	



LA5BIR80

Optional Mounting Accessories for LA5BIR80:

L3JB1 Junction box

Features:

- ◆ Manages & Protects Cables
- ◆ 3/4" Conduit Access
- ◆ For Indoor & Outdoor Use



L3JB1

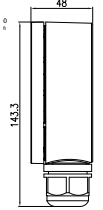
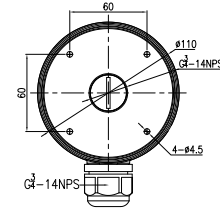
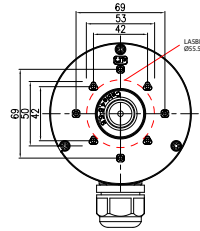

L3JB1 Lineart

L3POLEMT2 Pole mount

Features:

- ◆ Metal Straps Included
- ◆ For 5-6" Pole Diameters
- ◆ For Indoor & Outdoor Use



L3POLEMT2

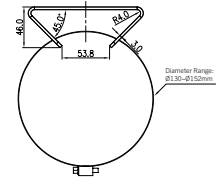
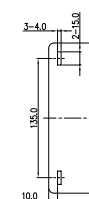
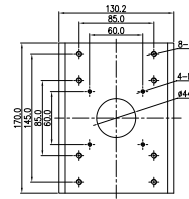

L3POLEMT2 Lineart

TECHNICAL SPECIFICATIONS

LA5PTZ33X

FEATURES:

- ◆ NDAA Compliant
- ◆ Supports TVI, CVI, AHD & 960H Formats
- ◆ 5MP Resolution (2560×1920) @20FPS
- ◆ 33X Optical Zoom (4.6 ~ 152mm)
- ◆ 12 High Power IR LED - 450' IR Range
- ◆ True Day/Night IR Cut Filter
- ◆ 360° Endless Panning
- ◆ UTC & RS-485 Control
- ◆ Pelco P & D Protocol
- ◆ 128 Preset Positions
- ◆ 4 Tours - Up to 32 Presets Each
- ◆ 4 Alarm Inputs / 1 Output
- ◆ -40° Operating Temp
- ◆ Built-in Heater & Fan
- ◆ Includes Wall Mount & 24VAC Power Supply
- ◆ IP66 Weatherproof

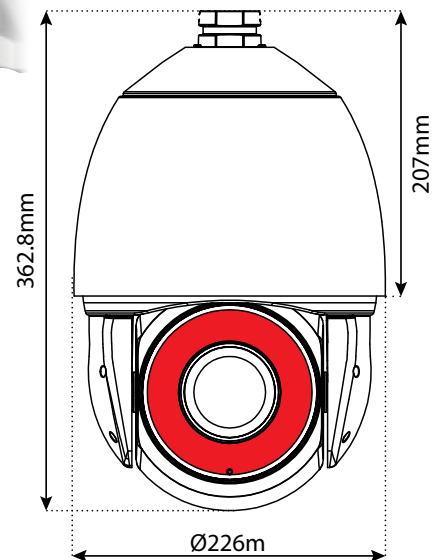

LA5PTZ33X

INCLUDED ACCESSORIES:

- 1x Quick start guide
- 3x Hex socket screws
- 2x Hex wrench
- 3x Mounting inserts & screws
- 1x 24VAC Power Adapter
- 1x Wall mount
- 2x Glove
- 3x Terminal block
- 1x Threaded mount adapter 1.5" NPT
- 1x Safety wire

WALL MOUNT DIMENSIONS

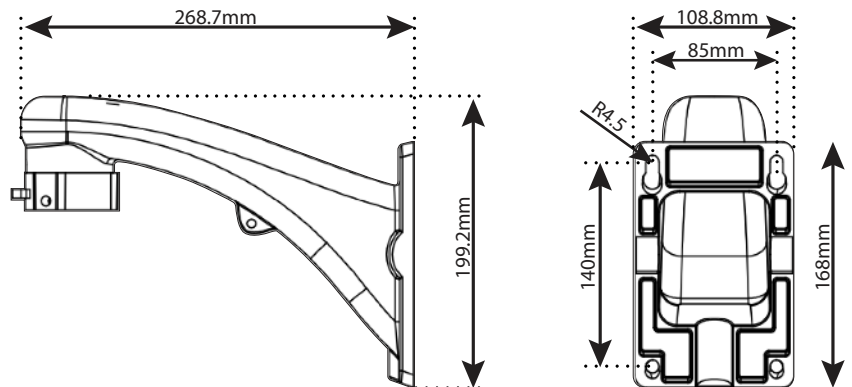

	SPECIFICATION	LA5PTZ33X
Camera	Image Sensor	1/2.7" Progressive Scan CMOS
	Image Resolution	5MP (2560x1920)
	Frame Rate	20fps
	Min. Illumination	Color: 0.01Lux @ (F1.2, AGC ON) B/W: 0Lux @ (IR LED ON)
	White Balance	Auto / ATW / AWC-Set / Indoor / Outdoor / Manual / AWB
	AGC	Auto (1 ~ 15 Adjustable)
	S/N Ratio	More than 52dB
	2D & 3D DNR	Auto / Off / Low / Middle / High
	Backlight Compensation	Off / On, (HLC Off / On)
	D-WDR (Wide Dynamic Range)	Digital WDR
	Shutter Time	AUTO, 1/25, 1/50, FLK, 1/200, 1/400, 1/1000, 1/2000, 1/5000, 1/10000, 1/50000, X2, X4, X6, X8, X10, X15, X20, X25, X30
	True Day & Night	Yes - Mechanical IR Cut Filter
	Digital Zoom	Yes: 1 ~ 20X
Privacy Mask	Yes: 4-Zone	
Input / Output	Video Output	Single BNC Output for TVI, CVI, AHD & 960H / Dipswitch for Switching Formats
	RS-485 Interface	Yes - Protocols: Pelco P & D (Auto-sensing) only
	UTC Function	Yes - Up the Coax Control Available
IR	IR LED / Distance / nM	12 IR LEDs / Up to 450' / 850nm
	IR Intensity	Proportional to Zoom Level
Lens	Focus Mode	Auto / Semi-Automatic / Manual
	Focal Length	4.6 ~ 152mm / 33X Optical Zoom
	Zoom Speed	Approx.6.2s (Optical Wide-Tele)
	Angle of View	H: 55.2° ~ 3.2°
	Min. Working Distance	11.8"
	Aperture	F1.6 ~ F4.8 (Auto IRIS)
Pan & Tilt	Pan Range	Pan: 0° ~ 360° Endless
	Pan Speed	Pan: 200° / Second
	Tilt Range	Tilt: 0° ~ +90°
	Tilt Speed	Tilt: 180° / Second
	Proportional Zoom	Auto Adjusts Speed for Zoom Level
	Number of Preset	128
	Tour	4 Tours - Adjustable Speed & Park Time
	Pattern	355° Programmable, 4 scan
	Power-off Memory	Yes - Tour, Preset, Pattern & Scan Can be Set
	Park Action	Yes - Tour, Preset, Pattern & Scan Can be Set
	Scheduled Task	Presets / Scan / Patterns / Tour
General	Menu Language	ENG /CHN 1/ CHN 2/ GER / FRA / ITA / SPA / POL / RUS / POR / NED / TUR
	Power Requirement	AC 24V / 2.5A (With the Heater On)
	Power Consumption	9W (IR OFF), 35W (IR ON)
	Operating Temperature	-40 °C ~ 60 °C (-40°F ~ 140 °F)
	Weatherproof Rating	IP66
	Certification	CE/FCC
	Dimensions	Ø226x.336.5mm - PTZ body only
	Housing / Color	Metal / White
	Included	Wall Mount & 24VAC Power Supply
Net Weight	5Kg (11.02 lb) - PTZ body only	

Optional Mounting Accessories for LA5PTZ33X:

L3PTZJB Junction box

Features:

- ◆ Manages & Protects Cables
- ◆ Hinged Door for Easy Installation
- ◆ 3/4" Conduit Access
- ◆ For Indoor & Outdoor Use



L3PTZJB

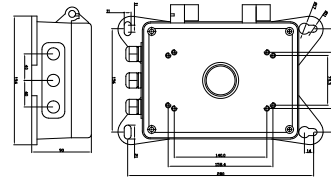

L3PTZJB Lineart

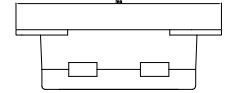

L3PTZPENDMT Pendant cap

Features:

- ◆ Pendant Mount for Dome Camera
- ◆ Aluminum Alloy
- ◆ For Indoor & Outdoor Use



L3PTZPENDMT

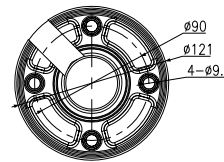

L3PTZPENDMT Lineart

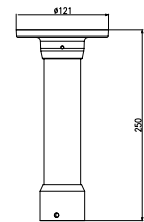

L3PTZCRNMT Outside corner mount

Features:

- ◆ For Indoor & Outdoor Use
- ◆ Heavy Duty Steel Construction



L3PTZCRNMT

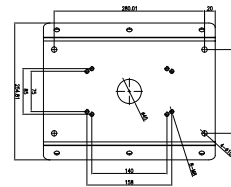

L3PTZCRNMT Lineart

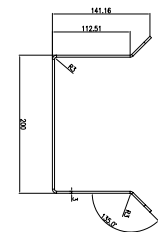

L3PTZPOLEMT Pole mount

Features:

- ◆ Metal Straps Included
- ◆ For 7-8" Pole Diameters
- ◆ For Indoor & Outdoor Use



L3PTZPOLEMT

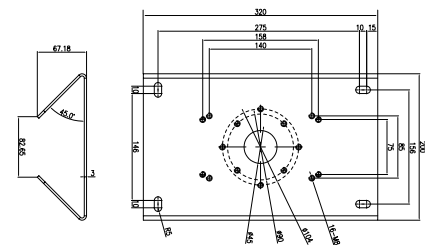

L3PTZPOLEMT Lineart

5MP Multi Format Outdoor Turret Camera 2.8mm, True WDR, Full Color, IP66

5MP NDAA 4-in-1 2.8mm Full Color

LA5TFC100



LA5TFC100

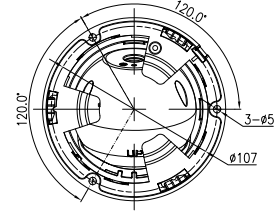
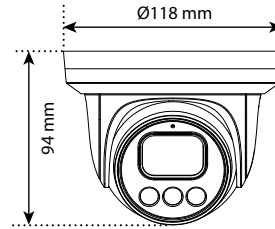

FEATURES:

- ◆ NDAA Compliant
- ◆ Supports TVI, CVI, AHD & 960H Formats
- ◆ 5MP Resolution (2560×1944) @20FPS
- ◆ True 120dB Wide Dynamic Range
- ◆ IR Cut Filter
- ◆ Fixed 2.8mm IR Lens
- ◆ Full Color, 3 White Light LED - 100' Range
- ◆ UTC & Cable OSD Control
- ◆ 12 Volt DC Power
- ◆ IP66 Weatherproof

INCLUDED ACCESSORIES:

- 1x Quick start guide
- 3x Mounting inserts & screws
- 1x Mounting template

	FEATURES	LA5TFC100
Camera	Image Sensor	1/2.8" CMOS
	Scanning System	Progressive Scan
	Resolution	5MP (2560×1944)
	Signal System	NTSC / PAL
	Shutter Speed	Auto, Manual 1/25 ~ 1/10,000
	Minimum Illumination	0.01Lux @ (F1.2, AGC ON), 0 Lux with light on
	S/N Ratio	More than 50dB
	Sync System	Internal
	Camera Bracket Adjustment	Pan: 0° ~ 355°, Tilt: 0° ~ 80°, Rotation: 0° ~ 360°
	Lens	Lens Type / Viewing Angle
IR Cut Filter		Yes
LED Count / Range		3 White Light LEDs / 100' Range
Video & OSD	Video Output	Single BNC Output - Supports TVI, CVI, AHD & 960H Formats (Selectable via OSD Cable)
	Frame Rate	AHD/TVI: 5MP @ 20/12.5fps, 4MP @ 25/30/15fps, CVI: 4MP @ 25/30fps, CVBS: PAL/NTSC
	True WDR (Wide Dynamic Range)	Yes- 120dB
	OSD (On Screen Display)	Dual OSD Access: Cable OSD Controlled / UTC Controlled (coaxial control)
	Day & Night	Yes - True Day/Night with IR Filter - Auto Switch
	DNR (Digital Noise Reduction)	2DNR & 3DNR, Auto / Manual (0-100 Adjustable)
	Automatic Gain Control	Auto, Manual 0 ~16 Adjustable
	Gamma Characteristics	$\gamma = 0.45$ typ
	White Balance	ATW, MWB - R & B Gain 0~32 Adjustable
	Back Light Compensation	Globe / BLC / 1~8 Adjustable
	Day/Night	EXT / Auto / Color / B/W
	Languages	English, French, Spanish, Italian (see OSD Menu for more)
	Brightness	0 ~30 Adjustable
General	Power Input	12 Volt DC Only $\pm 10\%$
	Power Consumption & Current	Max. 5W (12V DC, LED ON)
	Overall Camera Dimensions	$\varnothing 118 \times 94$ mm (4.65×3.7 inch)
	Housing / Color	Aluminum & Plastic / White
	Net Weight	0.5 kg (1.1 lb)
	Operating Temperature	-25 °C ~ 55 °C (-14°F ~ 131 °F)
	Weatherproof Rating	IP66

Optional Mounting Accessories for LA5TFC100:

L3JB3 Junction box

Features:

- ◆ Manages & Protects Cables
- ◆ 3/4" Conduit Access
- ◆ For Indoor & Outdoor Use



L3JB3

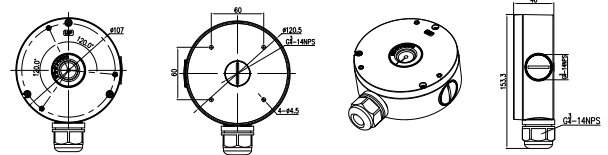

L3JB3 Lineart

L3HWM1 Wall mount

Features:

- * Requires L3PC3 Pendant Cap
- ◆ Manages & Protects Cables
- ◆ Hinged Wall Arm for Easy Installation
- ◆ Side, Back & Bottom 3/4" Conduit Access
- ◆ For Indoor & Outdoor Use

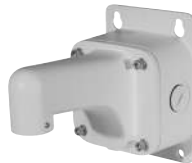

L3HWM1

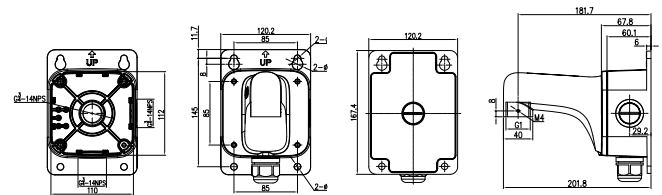

L3HWM1 Lineart

L3PC3 Pendant cap

Features:

- ◆ Pendant Mount for Dome Camera
- ◆ Aluminum Alloy
- ◆ For Indoor & Outdoor Use



L3PC3

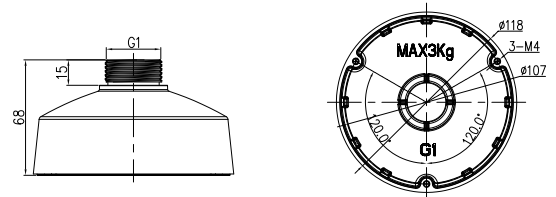

L3PC3 Lineart

L3CPM1 Pendant mount

Features:

- * Requires L3PC3 Pendant Cap
- ◆ 18" Drop Down Length
- ◆ For Use With or Without Drop Down Pipes
- ◆ Includes (2) 9" Drop Down Pipes
- ◆ Manages & Protects Cables
- ◆ For Indoor & Outdoor Use



L3CPM1

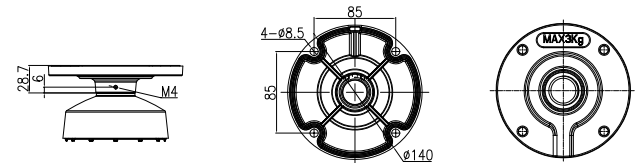

L3CPM1 Lineart

L3POLEMT2 Pole mount

Features:

- ◆ Metal Straps Included
- ◆ For 5-6" Pole Diameters
- ◆ For Indoor & Outdoor Use



L3POLEMT2

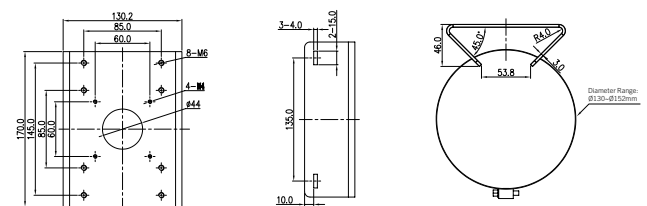

L3POLEMT2 Lineart

5MP Multi Format Outdoor Turret Camera 2.8mm, True WDR, 100' IR, IP66

TECHNICAL SPECIFICATIONS

5MP NDAA 4-in-1 2.8mm IR LED

LA5TIR80



LA5TIR80

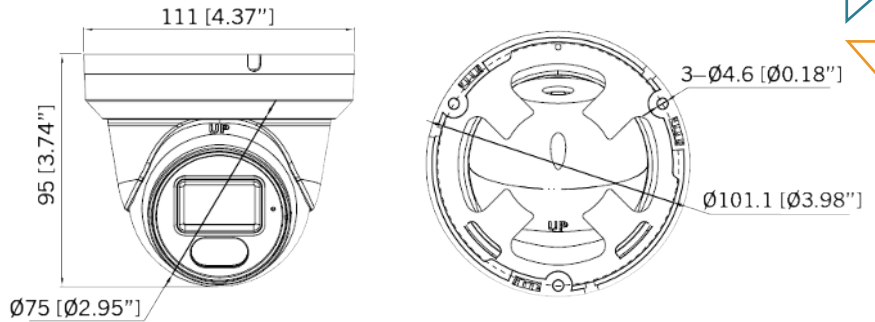

FEATURES:

- ◆ NDAA Compliant
- ◆ Supports TVI, CVI, AHD & 960H Formats
- ◆ 5MP Resolution (2560×1944) @20FPS
- ◆ True 120dB Wide Dynamic Range
- ◆ True Day/Night IR Cut Filter
- ◆ Fixed 2.8mm IR Lens
- ◆ Up to 80' IR Range
- ◆ UTC & Cable OSD Control
- ◆ 12 Volt DC Power
- ◆ IP66 Weatherproof

INCLUDED ACCESSORIES:

- 1x Quick start guide
- 3x Mounting inserts & screws
- 1x Mounting template

	FEATURES	LA5TIR80
Camera	Image Sensor	1/2.8" CMOS
	Scanning System	Progressive Scan
	Resolution	5MP (2560×1944)
	Signal System	NTSC / PAL
	Shutter Speed	Auto, Manual 1/25 ~ 1/10,000
	Minimum Illumination	Color: 0.01 Lux @ (F1.2, AGC ON); B/W: 0 Lux @ (IR LED ON)
	S/N Ratio	More than 50dB
	Sync System	Internal
	Camera Bracket Adjustment	Pan: 0° ~ 360°, Tilt: 0° ~ 85°, Rotation: 0° ~ 360°
	Lens	Lens Type / Viewing Angle
True Day/Night		Yes - Removeable IR Cut Filter
IR LED Count / Range / nM		2 IR LED's / 80' Range / 850nM
Video & OSD	Video Output	Single BNC Output - Supports TVI, CVI, AHD & 960H Formats (Selectable via OSD Cable)
	Frame Rate	AHD/TVI: 5MP @ 20/12.5fps, 4MP @ 25/30/15fps, CVI: 4MP @ 25/30fps, CVBS: PAL/NTSC
	True WDR (Wide Dynamic Range)	Yes- 120dB
	OSD (On Screen Display)	Dual OSD Access: Cable OSD Controlled / UTC Controlled (coaxial control)
	Day & Night	Yes - True Day/Night with IR Filter - Auto Switch
	DNR (Digital Noise Reduction)	2DNR & 3DNR, Auto / Manual (0-100 Adjustable)
	Automatic Gain Control	Auto, Manual 0 ~16 Adjustable
	Gamma Characteristics	y = 0.45 typ
	White Balance	ATW, MWB - R & B Gain 0~32 Adjustable
	Back Light Compensation	Globe / BLC / 1~8 Adjustable
	Day/Night	EXT / Auto / Color / B/W
	Languages	English, French, Spanish, Italian (see OSD Menu for more)
	Brightness	0 ~30 Adjustable
General	Power Input	12 Volt DC Only ±10%
	Power Consumption & Current	Max. 4.5W (12V DC, IR ON)
	Overall Camera Dimensions	Ø111×95 mm (4.37×3.74 inch)
	Housing / Color	Aluminum & Plastic / White
	Net Weight	0.35 kg (0.77 lb)
	Operating Temperature	-25 °C ~ 55 °C (-14°F ~ 131 °F)
	Weatherproof Rating	IP66



LA5TIR80

Optional Mounting Accessories for LA5TIR80:

L3JB3 Junction box

Features:

- ◆ Manages & Protects Cables
- ◆ 3/4" Conduit Access
- ◆ For Indoor & Outdoor Use



L3JB3

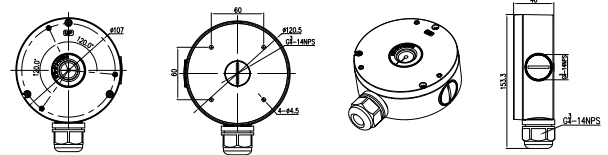

L3JB3 Lineart

L3POLEMT2 Pole mount

Features:

- ◆ Metal Straps Included
- ◆ For 5-6" Pole Diameters
- ◆ For Indoor & Outdoor Use



L3POLEMT2

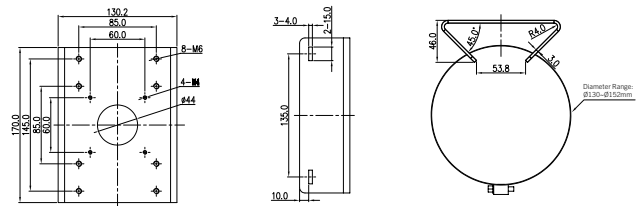

L3POLEMT2 Lineart

TECHNICAL SPECIFICATIONS



LA5TIR100



LA5TIR100

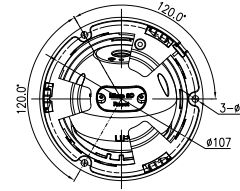
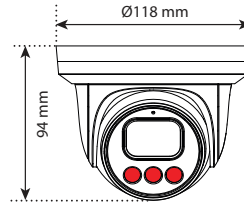

FEATURES:

- ◆ NDAA Compliant
- ◆ Supports TVI, CVI, AHD & 960H Formats
- ◆ 5MP Resolution (2560×1944) @20FPS
- ◆ True 120dB Wide Dynamic Range
- ◆ True Day/Night IR Cut Filter
- ◆ Fixed 2.8mm IR Lens
- ◆ Up to 100' IR Range
- ◆ UTC & Cable OSD Control
- ◆ 12 Volt DC Power
- ◆ IP66 Weatherproof

INCLUDED ACCESSORIES:

- 1x Quick start guide
- 3x Mounting inserts & screws
- 1x Mounting template

	FEATURES	LA5TIR100
Camera	Image Sensor	1/2.8" CMOS
	Scanning System	Progressive Scan
	Resolution	5MP (2560×1944)
	Signal System	NTSC / PAL
	Shutter Speed	Auto, Manual 1/25 ~ 1/10,000
	Minimum Illumination	Color: 0.01 Lux @ (F1.2, AGC ON); B/W: 0 Lux @ (IR LED ON)
	S/N Ratio	More than 50dB
	Sync System	Internal
	Camera Bracket Adjustment	Pan: 0° ~ 355°, Tilt: 0° ~ 80°, Rotation: 0° ~ 360°
	Lens	Lens Type / Viewing Angle
True Day/Night		Yes - Removeable IR Cut Filter
IR LED Count / Range / nM		3 IR LED's / 100' Range / 850nm
Video & OSD	Video Output	Single BNC Output - Supports TVI, CVI, AHD & 960H Formats (Selectable via OSD Cable)
	Frame Rate	AHD/TVI: 5MP @ 20/12.5fps, 4MP @ 25/30/15fps, CVI: 4MP @ 25/30fps, CVBS: PAL/NTSC
	True WDR (Wide Dynamic Range)	Yes- 120dB
	OSD (On Screen Display)	Dual OSD Access: Cable OSD Controlled / UTC Controlled (coaxial control)
	Day & Night	Yes - True Day/Night with IR Filter - Auto Switch
	DNR (Digital Noise Reduction)	2DNR & 3DNR, Auto / Manual (0-100 Adjustable)
	Automatic Gain Control	Auto, Manual 0 ~16 Adjustable
	Gamma Characteristics	y = 0.45 typ
	White Balance	ATW, MWB - R & B Gain 0~32 Adjustable
	Back Light Compensation	Globe / BLC / 1~8 Adjustable
	Day/Night	EXT / Auto / Color / B/W
	Languages	English, French, Spanish, Italian (see OSD Menu for more)
	Brightness	0 ~30 Adjustable
General	Power Input	12 Volt DC Only ±10%
	Power Consumption & Current	Max. 5W (12V DC, IR ON)
	Overall Camera Dimensions	Ø118×94 mm (4.65×3.7 inch)
	Housing / Color	Aluminum & Plastic / White
	Net Weight	0.5 kg (1.1 lb)
	Operating Temperature	-25 °C ~ 55 °C (-14°F ~ 131 °F)
Weatherproof Rating	IP66	

TECHNICAL SPECIFICATIONS



LA5TIR100

Optional Mounting Accessories for LA5TIR100:

L3JB3 Junction box

Features:

- ◆ Manages & Protects Cables
- ◆ 3/4" Conduit Access
- ◆ For Indoor & Outdoor Use



L3JB3

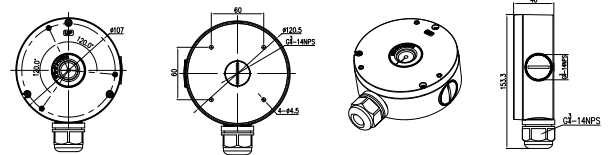

L3JB3 Lineart

L3HWM1 Wall mount

Features:

- * Requires L3PC3 Pendant Cap
- ◆ Manages & Protects Cables
- ◆ Hinged Wall Arm for Easy Installation
- ◆ Side, Back & Bottom 3/4" Conduit Access
- ◆ For Indoor & Outdoor Use



L3HWM1

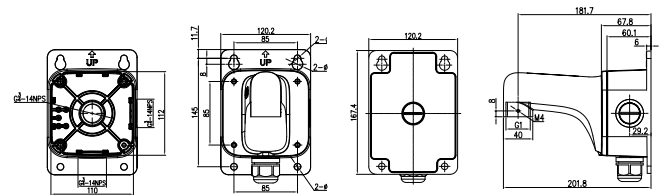

L3HWM1 Lineart

L3PC3 Pendant cap

Features:

- ◆ Pendant Mount for Dome Camera
- ◆ Aluminum Alloy
- ◆ For Indoor & Outdoor Use



L3PC3

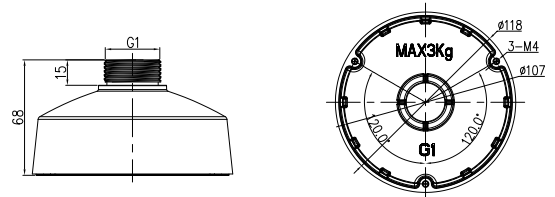

L3PC3 Lineart

L3CPM1 Pendant mount

Features:

- * Requires L3PC3 Pendant Cap
- ◆ 18" Drop Down Length
- ◆ For Use With or Without Drop Down Pipes
- ◆ Includes (2) 9" Drop Down Pipes
- ◆ Manages & Protects Cables
- ◆ For Indoor & Outdoor Use



L3CPM1

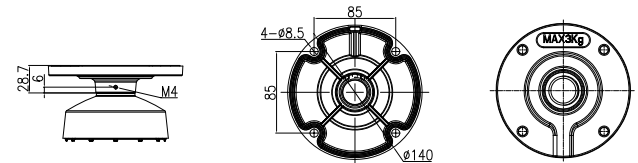

L3CPM1 Lineart

L3POLEMT2 Pole mount

Features:

- ◆ Metal Straps Included
- ◆ For 5-6" Pole Diameters
- ◆ For Indoor & Outdoor Use



L3POLEMT2

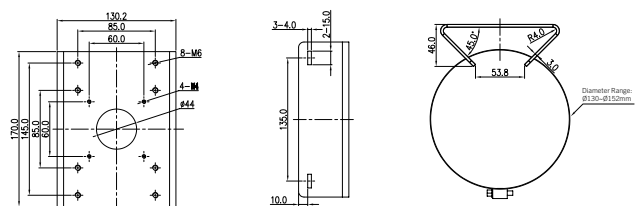

L3POLEMT2 Lineart

TECHNICAL SPECIFICATIONS

5MP NDAA 4-in-1 2.7~13.5mm IR LED

LA5VFBIR120



LA5VFBIR120

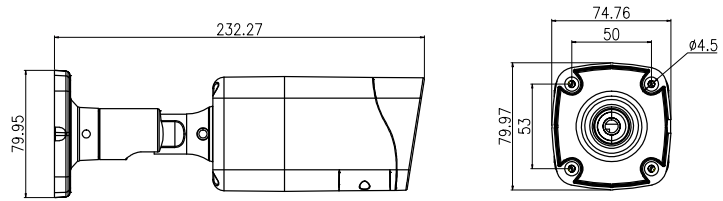

FEATURES:

- ◆ NDAA Compliant
- ◆ Supports TVI, CVI, AHD & 960H Formats
- ◆ 5MP Resolution (2560×1944) @20FPS
- ◆ True 120dB Wide Dynamic Range
- ◆ True Day/Night IR Cut Filter
- ◆ Auto Focus 2.7 ~ 13.5mm IR Lens
- ◆ Up to 120' IR Range
- ◆ UTC & Cable OSD Control
- ◆ 12VDC/24VAC Dual Voltage Power
- ◆ IP67 Weatherproof

INCLUDED ACCESSORIES:

- 1x Quick start guide
- 1x Hex wrench
- 4x Mounting inserts & screws
- 1x Mounting template

	FEATURES	LA5VFBIR120
Camera	Image Sensor	1/2.8" CMOS
	Scanning System	Progressive Scan
	Resolution	5MP (2560×1944)
	Signal System	NTSC / PAL
	Shutter Speed	Auto, Manual 1/25 ~ 1/10,000
	Minimum Illumination	Color: 0.01 Lux @ (F1.2,AGC ON); B/W: 0 Lux @ (IR LED ON)
	S/N Ratio	More than 50dB
	Sync System	Internal
	Camera Bracket Adjustment	Pan:0°~360°; Tilt:0°~90°; Rotation:0°~360°
	Lens	Lens Type / Viewing Angle
True Day/Night		Yes - Removeable IR Cut Filter
IR LED Count / Range / nM		4 IR LED's / 120' Range / 850nm
Video & OSD	Video Output	Single BNC Output - Supports TVI, CVI, AHD & 960H Formats (Selectable via OSD Cable)
	Frame Rate	AHD/TVI: 5MP @ 20/12.5fps, 4MP @ 25/30/15fps, CVI: 4MP @ 25/30fps, CVBS: PAL/NTSC
	True WDR (Wide Dynamic Range)	Yes- 120dB
	OSD (On Screen Display)	Dual OSD Access: Cable OSD Controlled / UTC Controlled (coaxial control)
	Day & Night	Yes - True Day/Night with IR Filter - Auto Switch
	DNR (Digital Noise Reduction)	2DNR & 3DNR, Auto / Manual (0-100 Adjustable)
	Automatic Gain Control	Auto, Manual 0 ~16 Adjustable
	Gamma Characteristics	y = 0.45 typ
	White Balance	ATW, MWB - R & B Gain 0~32 Adjustable
	Back Light Compensation	Globe / BLC / 1~8 Adjustable
	Day/Night	EXT / Auto / Color / B/W
	Languages	English, French, Spanish, Italian (see OSD Menu for more)
	Brightness	0 ~30 Adjustable
General	Power Input	12VDC/24VAC Dual Voltage Power ±10%
	Power Consumption & Current	Max. 5.5W (12V DC, IR ON)
	Overall Camera Dimensions	232 × 80 × 80 mm (9.14 x 3.15 x 3.15 inch)
	Housing / Color	Aluminum / White
	Net Weight	0.65 kg (1.43 lb)
	Operating Temperature	-25 °C ~ 55 °C (-14°F ~ 131 °F)
	Weatherproof Rating	IP67

5MP Multi Format Outdoor Varifocal Bullet Camera 2.7~13.5mm, True WDR, 120' IR, IP67



LA5VFBIR120

Optional Mounting Accessories for LA5VFBIR120:

L3JB1 Junction box

Features:

- ◆ Manages & Protects Cables
- ◆ 3/4" Conduit Access
- ◆ For Indoor & Outdoor Use



L3JB1

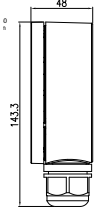
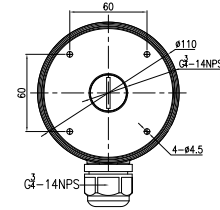
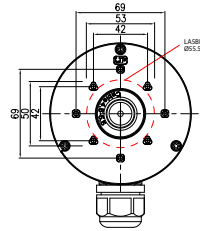

L3JB1 Lineart

L3POLEMT2 Pole mount

Features:

- ◆ Metal Straps Included
- ◆ For 5-6" Pole Diameters
- ◆ For Indoor & Outdoor Use



L3POLEMT2

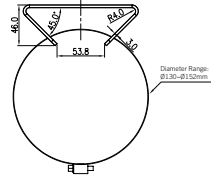
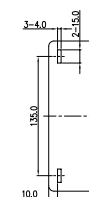
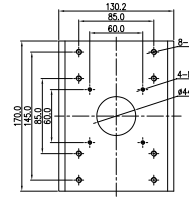

L3POLEMT2 Lineart

TECHNICAL SPECIFICATIONS

5MP NDAA 4-in-1 2.7~13.5mm IR LED

LA5VFDIR100



LA5VFDIR100

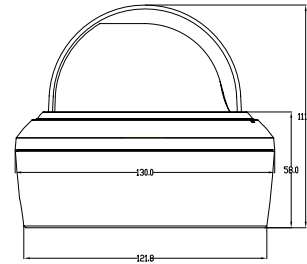
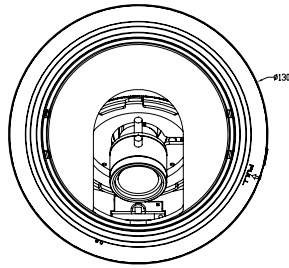

FEATURES:

- ◆ NDAA Compliant
- ◆ Supports TVI, CVI, AHD & 960H Formats
- ◆ 5MP Resolution (2560×1944) @20FPS
- ◆ True 120dB Wide Dynamic Range
- ◆ True Day/Night IR Cut Filter
- ◆ Auto Focus 2.7 ~ 13.5mm IR Lens
- ◆ Up to 100' IR Range
- ◆ UTC & Cable OSD Control
- ◆ 12VDC/24VAC Dual Voltage Power
- ◆ IK10 Rated & IP66 Weatherproof

INCLUDED ACCESSORIES:

- 1x Quick start guide
- 1x Hex wrench
- 3x Mounting accessory screws
- 3x Mounting inserts & screws
- 1x Mounting template

	FEATURES	LA5VFDIR100
Camera	Image Sensor	1/2.8" CMOS
	Scanning System	Progressive Scan
	Resolution	5MP (2560×1944)
	Signal System	NTSC / PAL
	Shutter Speed	Auto, Manual 1/25 ~ 1/10,000
	Minimum Illumination	Color: 0.01 Lux @ (F1.2, AGC ON); B/W: 0 Lux @ (IR LED ON)
	S/N Ratio	More than 50dB
	Sync System	Internal
	Camera Bracket Adjustment	Pan:0°~355°; Tilt:0°~75°; Rotation:0°~355°
Lens	Lens Type / Viewing Angle	2.7~13.5mm IR Lens / H: 100.8°~32°, V: 74°~24.5°
	True Day/Night	Yes - Removeable IR Cut Filter
	IR LED Count / Range / nM	4 IR LED's / 100' Range / 850nm
Video & OSD	Video Output	Single BNC Output - Supports TVI, CVI, AHD & 960H Formats (Selectable via OSD Cable)
	Frame Rate	AHD/TVI: 5MP @ 20/12.5fps, 4MP @ 25/30/15fps, CVI: 4MP @ 25/30fps, CVBS: PAL/NTSC
	True WDR (Wide Dynamic Range)	Yes- 120dB
	OSD (On Screen Display)	Dual OSD Access: Cable OSD Controlled / UTC Controlled (coaxial control)
	Day & Night	Yes - True Day/Night with IR Filter - Auto Switch
	DNR (Digital Noise Reduction)	2DNR & 3DNR, Auto / Manual (0-100 Adjustable)
	Automatic Gain Control	Auto, Manual 0 ~16 Adjustable
	Gamma Characteristics	y = 0.45 typ
	White Balance	ATW, MWB - R & B Gain 0~32 Adjustable
	Back Light Compensation	Globe / BLC / 1~8 Adjustable
	Day/Night	EXT / Auto / Color / B/W
	Languages	English, French, Spanish, Italian (see OSD Menu for more)
	Brightness	0 ~30 Adjustable
General	Power Input	12VDC/24VAC Dual Voltage Power ±10%
	Power Consumption & Current	Max. 6.5W (12V DC, IR ON)
	Overall Camera Dimensions	∅130 × 112mm (∅5.12" × 4.41")
	Housing / Color	Aluminum / White
	Net Weight	0.67 kg (1.48 lb)
	Operating Temperature	-25 °C ~ 55 °C (-14°F ~ 131 °F)
	Weatherproof / Impact Ratings	IP67 / IK10



Optional Mounting Accessories for LA5VFDIR100:

L3JB5 Junction box

Features:

- ◆ Manages & Protects Cables
- ◆ 3/4" Conduit Access
- ◆ For Indoor & Outdoor Use



L3JB5

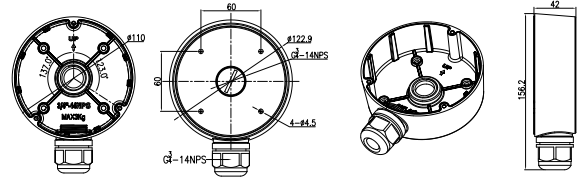

L3JB5 Lineart

L3HWM1 Wall mount

Features:

- * Requires L3PC5 Pendant Cap
- ◆ Manages & Protects Cables
- ◆ Hinged Wall Arm for Easy Installation
- ◆ Side, Back & Bottom 3/4" Conduit Access
- ◆ For Indoor & Outdoor Use

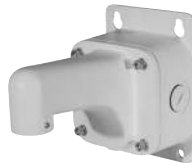

L3HWM1

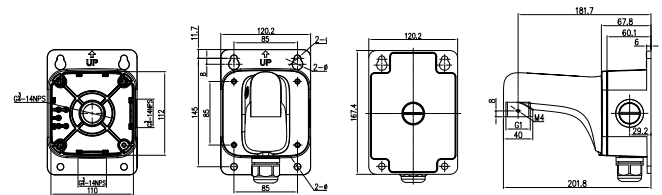

L3HWM1 Lineart

L3PC5 Pendant cap

Features:

- ◆ Pendant Mount for Dome Camera
- ◆ Aluminum Alloy
- ◆ For Indoor & Outdoor Use



L3PC5

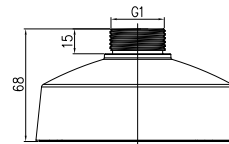

L3PC5 Lineart

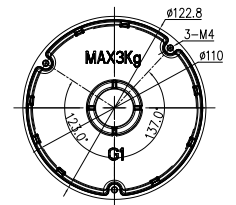

L3CPM1 Pendant mount

Features:

- * Requires L3PC5 Pendant Cap
- ◆ 18" Drop Down Length
- ◆ For Use With or Without Drop Down Pipes
- ◆ Includes (2) 9" Drop Down Pipes
- ◆ Manages & Protects Cables
- ◆ For Indoor & Outdoor Use



L3CPM1

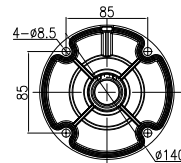
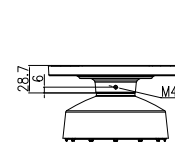

L3CPM1 Lineart

L3POLEMT2 Pole mount

Features:

- ◆ Metal Straps Included
- ◆ For 5-6" Pole Diameters
- ◆ For Indoor & Outdoor Use



L3POLEMT2

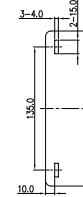
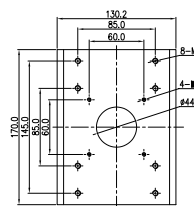

L3POLEMT2 Lineart

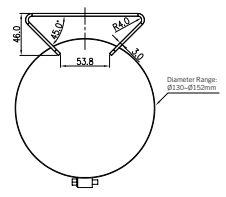

5MP Multi Format Outdoor Varifocal Dome Camera 2.7~13.5mm, True WDR, 100' IR, Indoor Only

TECHNICAL SPECIFICATIONS

5MP NDAА 4-in-1 2.7~13.5mm IR LED Indoor

LA5VFDIR100IN



LA5VFDIR100IN

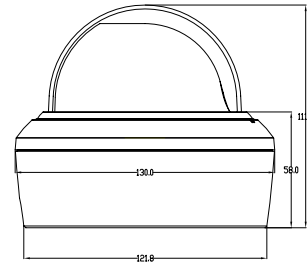
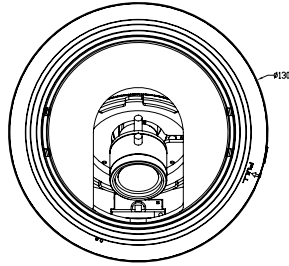

FEATURES:

- ◆ NDAА Compliant
- ◆ Supports TVI, CVI, AHD & 960H Formats
- ◆ 5MP Resolution (2560×1944) @20FPS
- ◆ True 120dB Wide Dynamic Range
- ◆ True Day/Night IR Cut Filter
- ◆ Auto Focus 2.7 ~ 13.5mm IR Lens
- ◆ Up to 100' IR Range
- ◆ UTC & Cable OSD Control
- ◆ 12VDC/24VAC Dual Voltage Power
- ◆ Indoor Only

INCLUDED ACCESSORIES:

- 1x Quick start guide
- 1x Hex wrench
- 3x Mounting accessory screws
- 3x Mounting inserts & screws
- 1x Mounting template

	FEATURES	LA5VFDIR100IN
Camera	Image Sensor	1/2.8" CMOS
	Scanning System	Progressive Scan
	Resolution	5MP (2560×1944)
	Signal System	NTSC / PAL
	Shutter Speed	Auto, Manual 1/25 ~ 1/10,000
	Minimum Illumination	Color: 0.01 Lux @ (F1.2, AGC ON); B/W: 0 Lux @ (IR LED ON)
	S/N Ratio	More than 50dB
	Sync System	Internal
	Camera Bracket Adjustment	Pan:0°~355°; Tilt:0°~75°; Rotation:0°~355°
Lens	Lens Type / Viewing Angle	2.7~13.5mm IR Lens / H: 100.8°~32°, V: 74°~24.5°
	True Day/Night	Yes - Removeable IR Cut Filter
	IR LED Count / Range / nM	4 IR LED's / 100' Range / 850nm
Video & OSD	Video Output	Single BNC Output - Supports TVI, CVI, AHD & 960H Formats (Selectable via OSD Cable)
	Frame Rate	AHD/TVI: 5MP @ 20/12.5fps, 4MP @ 25/30/15fps, CVI: 4MP @ 25/30fps, CVBS: PAL/NTSC
	True WDR (Wide Dynamic Range)	Yes- 120dB
	OSD (On Screen Display)	Dual OSD Access: Cable OSD Controlled / UTC Controlled (coaxial control)
	Day & Night	Yes - True Day/Night with IR Filter - Auto Switch
	DNR (Digital Noise Reduction)	2DNR & 3DNR, Auto / Manual (0-100 Adjustable)
	Automatic Gain Control	Auto, Manual 0 ~16 Adjustable
	Gamma Characteristics	y = 0.45 typ
	White Balance	ATW, MWB - R & B Gain 0~32 Adjustable
	Back Light Compensation	Globe / BLC / 1~8 Adjustable
	Day/Night	EXT / Auto / Color / B/W
	Languages	English, French, Spanish, Italian (see OSD Menu for more)
	Brightness	0 ~30 Adjustable
General	Power Input	12VDC/24VAC Dual Voltage Power ±10%
	Power Consumption & Current	Max. 6.5W (12V DC, IR ON)
	Overall Camera Dimensions	Ø130 × 112mm (Ø5.12" × 4.41")
	Housing / Color	Aluminum / White
	Net Weight	0.45 kg (0.99 lb)
	Operating Temperature	-10 °C ~ 55 °C (14°F ~ 131 °F)
	Weatherproof Rating	Indoor Only

TECHNICAL SPECIFICATIONS



LA5VFDIR100IN

Optional Mounting Accessories for LA5VFDIR100IN:

L3JB5 Junction box

Features:

- ◆ Manages & Protects Cables
- ◆ 3/4" Conduit Access
- ◆ For Indoor & Outdoor Use



L3JB5

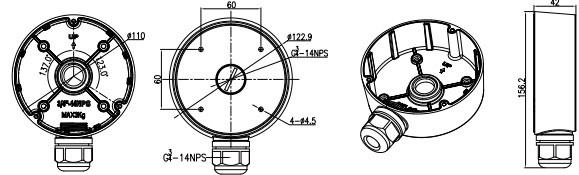

L3JB5 Lineart

L3HWM1 Wall mount

Features:

- * Requires L3PC5 Pendant Cap
- ◆ Manages & Protects Cables
- ◆ Hinged Wall Arm for Easy Installation
- ◆ Side, Back & Bottom 3/4" Conduit Access
- ◆ For Indoor & Outdoor Use

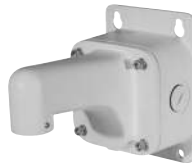

L3HWM1

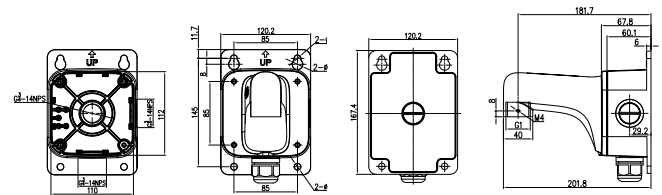

L3HWM1 Lineart

L3PC5 Pendant cap

Features:

- ◆ Pendant Mount for Dome Camera
- ◆ Aluminum Alloy
- ◆ For Indoor & Outdoor Use



L3PC5

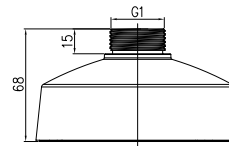

L3PC5 Lineart

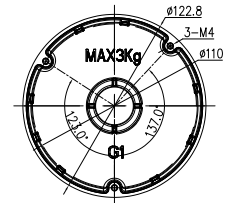

L3CPM1 Pendant mount

Features:

- * Requires L3PC5 Pendant Cap
- ◆ 18" Drop Down Length
- ◆ For Use With or Without Drop Down Pipes
- ◆ Includes (2) 9" Drop Down Pipes
- ◆ Manages & Protects Cables
- ◆ For Indoor & Outdoor Use



L3CPM1

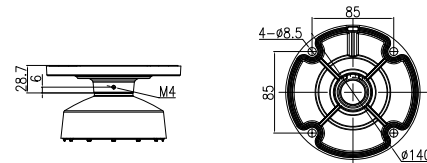

L3CPM1 Lineart

L3POLEMT2 Pole mount

Features:

- ◆ Metal Straps Included
- ◆ For 5-6" Pole Diameters
- ◆ For Indoor & Outdoor Use



L3POLEMT2

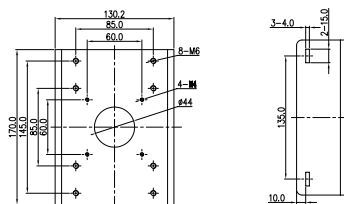

L3POLEMT2 Lineart

